SERVICE INSTRUCTION

SHORT STOPPER HOSE ASSEMBLY FOR VECTOR SOLO APPLICATOR

A short stopper hose assembly is now available for the Vector Solo applicator. The short stopper is used when the coiled fluid tube (p/n 79871-00) does not adequately isolate highly conductive solvent based materials from ground. In those applications, the short stopper is used. The following assemblies are available for purchase:

SHORT STOPPER ASSEMBLIES	
Part #	Description
77821-12	1.2m (4') Long 3/16" ID Grounded Fluid Hose Assembly
77821-30	3.0m (10') Long 3/16" ID Grounded Fluid Hose Assembly
77821-76	7.6m (25') Long 3/16" ID Grounded Fluid Hose Assembly
77822-12	1.2m (4') Long 1/4" ID Grounded Fluid Hose Assembly
77822-30	3.0m (10') Long 1/4" ID Grounded Fluid Hose Assembly
77822-76	7.6m (25') Long 1/4" ID Grounded Fluid Hose Assembly

In order for the short stopper assembly to work properly, it must be correctly installed onto a current Vector Solo applicator. The following steps describe how to convert a standard Vector Solo applicator to use a short stopper assembly.

Converting a Standard Vector Solo To Use a Short Stopper Assembly

1. First, remove the fluid tube from the fluid fitting. Second, remove the three (3) screws from the base of the power module. Finally, remove the power module from the handle by pulling straight down.

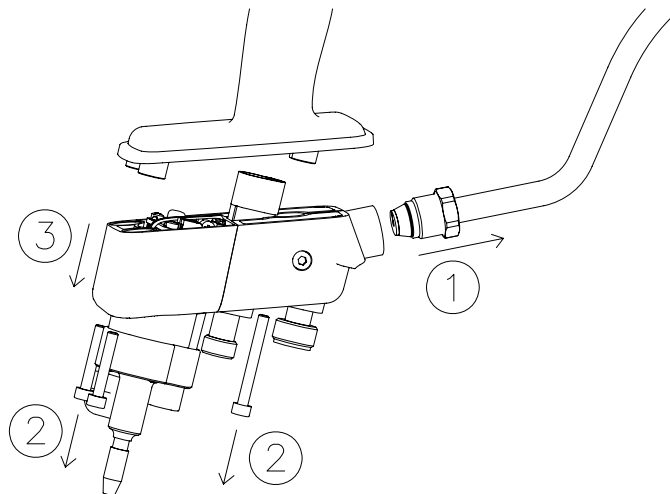

2. Next, remove the two (2) screws from the sides of the power module.

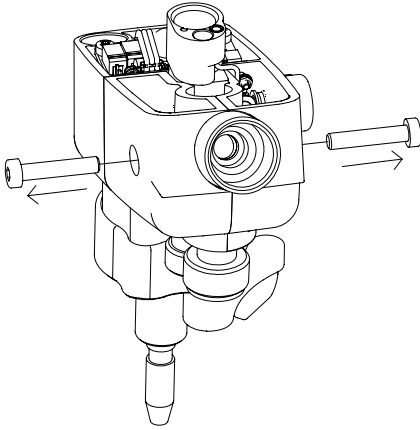

3. Pull apart the two pieces of the power module and remove the fluid fitting.

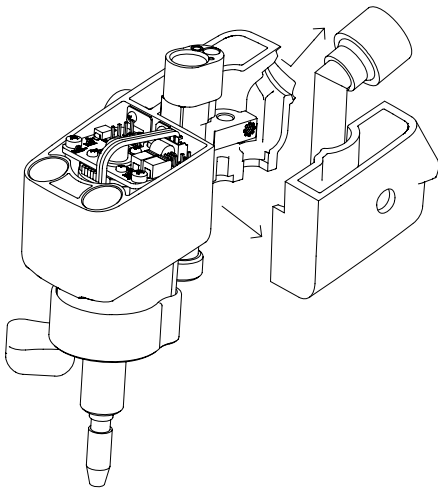

4. Install the new short stopper fitting [1].

NOTE: Ensure the ground strap [2] is installed in the power module and makes contact with the new short stopper fitting [1] as well as the air fitting [3].

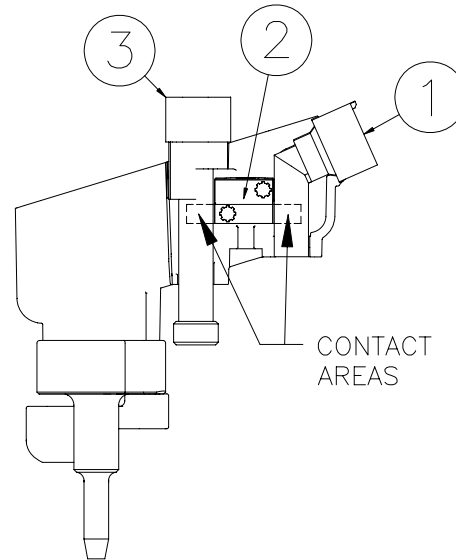

5. Place the two power module pieces together and re-install the two (2) screws in sides of the power module.

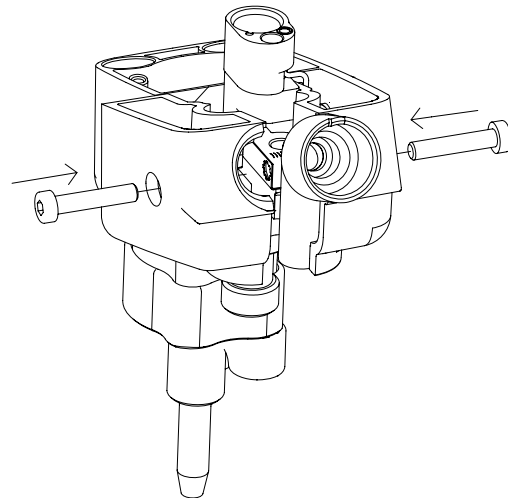

6. Install the hose bracket [1] onto the new short stopper fitting [2] using the bracket nut [3].

NOTE: Make sure to align the notch on the new short stopper fitting [2] with the groove on the hose bracket [1].

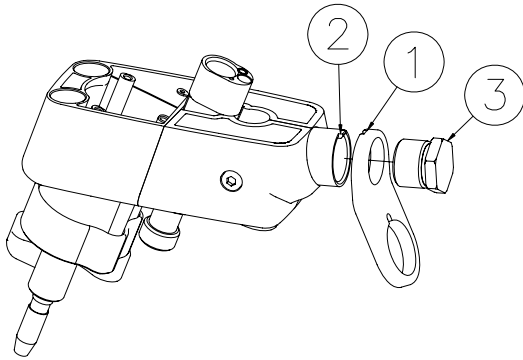

b. Insert the short stopper hose [1], with the conductive ferrule [3] and bulkhead connector [2] still on the hose, through the hole in the hose bracket [9].

NOTE: Make sure to align the pin on the bulkhead connector [2] with the hole on the hose bracket [9].

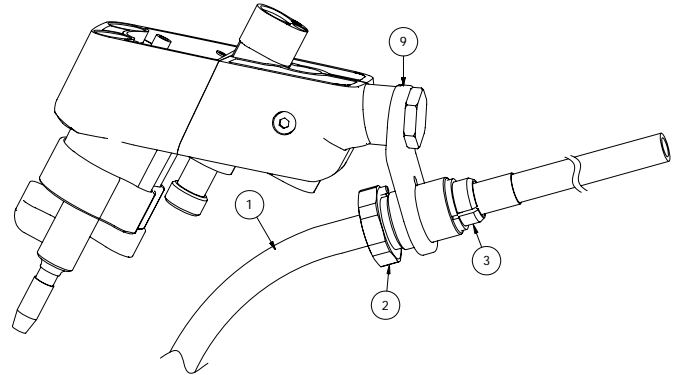

7. Install the short stopper hose into the hose bracket following these steps:

a. Remove the two (2) ferrules [7 and 8], connector nut [6], Nylo-Seal nut [5], and the thin jam nut [4] from the short stopper hose [1]. Do not discard. These pieces will be reinstalled onto the short stopper hose.

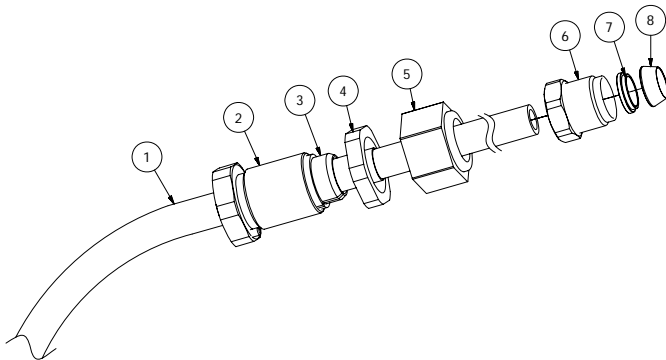

c. Tighten the thin jam nut [4] onto the bulkhead connector [2]. Tighten the Nylo-Seal nut [5] onto the bulkhead connector [2].

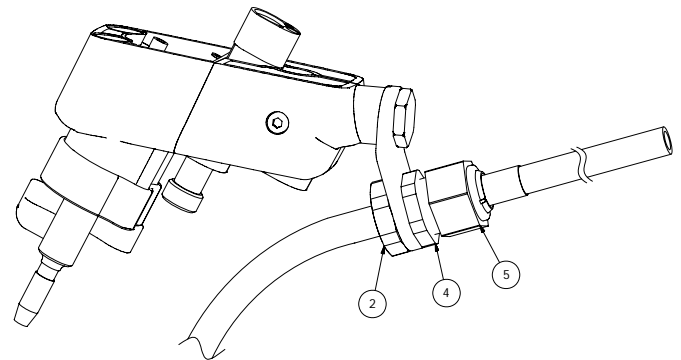

PARTS LIST	
Item	Description
1	Short Stopper Hose
2	Bulkhead Connector
3	Conductive Ferrule
4	Thin Jam Nut
5	Nylo-Seal Nut
6	Connector Nut
7	Ferrule, Front, 3/8" Tube
8	Ferrule, Back, 3/8" Tube

d. Re-install the power module onto the handle and tighten the three (3) screws.

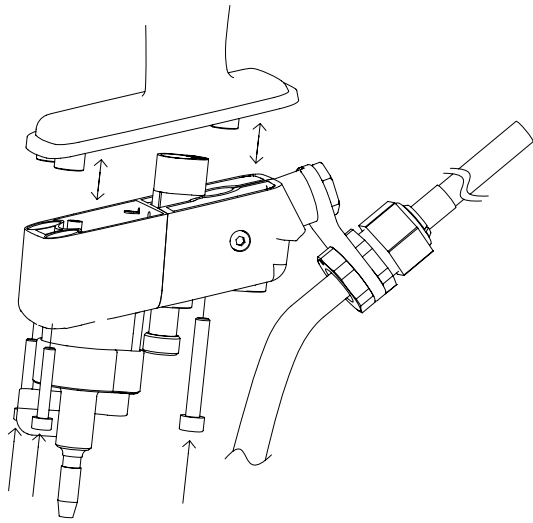

e. Place the connector nut [6] and two (2) ferrules [7 and 8] onto the short stopper hose. Insert hose into the barrel and tighten the connector nut [6].

NOTE: Hose may need to be trimmed to proper length (approximately 213mm (8 3/8") measured from the top face of the bracket).

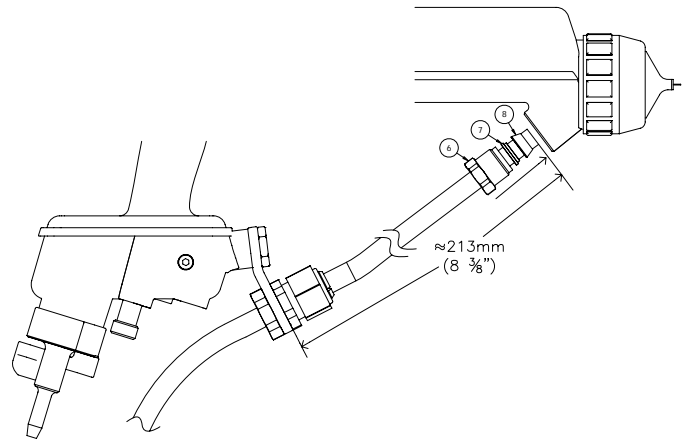

Manufacturing

1910 North Wayne Street
Angola, Indiana 46703-9100
Telephone: 260/665-8800
Fax: 260/665-8516

Technical/Service Assistance

Automotive Assembly and Tier I
Industrial Systems
Ransburg Guns
www.itwransburg.com

Telephone: 800/ 626-3565 Fax: 419/ 470-2040
Telephone: 800/ 233-3366 Fax: 419/ 470-2071
Telephone: 800/ 233-3366 Fax: 419/ 470-2071

Technical Support Representative will direct you to the appropriate telephone number for ordering Spare Parts.